

BAVARIA C46

Penelope (2025)

Member of
NAUTIC ALLIANCE **NA**

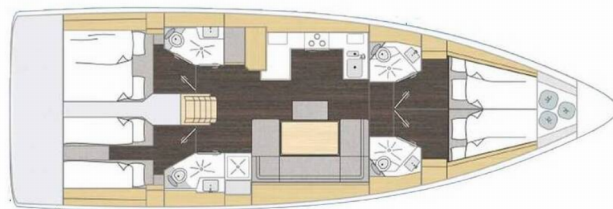

Technical specification

Yacht ID	137
Brand	Bavaria Yachtbau
Name	Penelope
Production year	2025
Length	49 ft
Cabins	4
Berths	8 + 1
Head/Shower	4

Purchase price: 410.500 €

Contact person:

Mr Marko Zacherl: marko.zacherl@nauticalliance.com | +49 172 130 9999

Mr Klaus Pitter: klaus.pitter@nauticalliance.com | +43 3332 66 240-15

Standard yacht equipment

Deck: Anchor line, Anchor swivel, Bathing platform, Bimini top, Black ball, Black conus, Boat hook, Bosun's chair (Safe seat) (boatswain's chair), Canister for water, Chairs, Cockpit cushions, Cockpit full tent, Cockpit table, Cockpit/stern, outside shower, Davit, Dinghy, Electric anchor windlass, Fenders, Gangway, Hawser, Jerry cans for diesel, Main anchor, Mooring ropes, Plastic bucket, Remote control for anchor winch with chain counter at helm, Round/globular fender, Spare anchor (Reserve, Auxiliary anchor), Spotlight / Headlights, Spring line, Water hose

Entertainment : Outside speakers, Radio, Wi-Fi Internet

Galley: Gas bottles, Hot water, Kitchen utensils (Galley equipment, cutlery), Refrigerator

Interior: Barometer, Bed linen, Clock, Electric fans in cabins, Electric toilet, Inside shower

Navigation: AIS, Autopilot, Binoculars with integrated compass, GPS chart plotter - cockpit, Harbour guides, Logge/Lot/Speed/Wind, Navigation (Nautical) charts and nautical guide, Navigation set, Radar, Radar reflector

Safety: Distress flare box, Fire extinguisher, First aid kit, Fog horn, Life belts (Safety harness), Life buoy + Flashing light, Liferaft, Self inflating life vest

Sails: Electric winch, Gennaker-device, Lazy bag, Lazy jacks

Yacht electrics: Battery charger, Heating, Inverter, Shore connection 220 V, Solar panels, VHF radio

Other: 3 blade folding propeller, Dinghy (byboat) pump, Flashlight, Impeller, V-belt, oilfilter, Repair box for dinghy, Set of tools, Wire (shroud) cutter

