

BAVARIA CRUISER 46

Attalya 1 (2014)

Member of
NAUTIC ALLIANCE **NA**

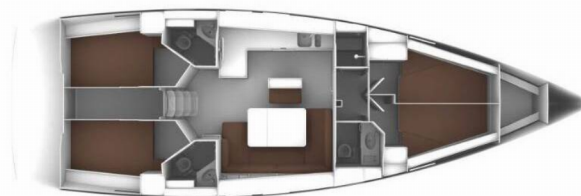

Especificación técnica

Base de charter	Golfo Aranci Marina Dell'Isola, Italia
Yate ID	148
Marca	Bavaria Yachtbau
Nombre	Attalya 1
Año de producción	2014
Longitud	47 ft
Camarotes	4
Literas	8 + 1
Baño/Ducha	3

Purchase price: 119.000 €

Contact person:

BAVARIA CRUISER 46

Attalya 1 (2014)



Equipamiento estándar del yate

Comfort: Bed linen, Cockpit cushions

Deck: Anchor line, Anchor swivel, Bathing platform, Bimini top, Black ball, Black conus, Boat hook, Bosun's chair (Safe seat) (boatswain's chair), Canister for water, Cockpit table with light, Cockpit/stern, outside shower, Dinghy, Dinghy (byboat) pump, Electric anchor windlass, Fenders, Gangway, Hawser, Impeller, V-belt, oilfilter, Jerry cans for diesel, Main anchor, Mooring ropes , Plastic bucket, Repair box for dinghy, Round/globular fender, Spare anchor (Reserve, Auxiliary anchor), Sprayhood, Spring line, Teak cockpit, Teak deck, Water hose

Entertainment: Outdoor speakers, Radio, Wi-Fi Internet

Galley: Gas bottles, Hot water, Kitchen utensils (Galley equipment, cutlery), Refrigerator

Interior: Barometer, Clock, Electric toilet, Inside shower

Navigation: Autopilot, Bow thruster, Bretonplotter, Composite steering wheels, GPS chart plotter - cockpit, Harbour guides, Logge/Lot/Speed/Wind, Navigation (Nautical) charts and nautical guide , Navigation set, Radar reflector, Spyglass with bearing compass, Tridata, Windex

Safety: Fire extinguisher , First aid kit , Flashlight, Fog horn, Life belts (Safety harness), Life buoy + Flashing light, Liferaft , Light and rope for horseshoe life buoy, Self inflating life vest, Set of tools , VHF radio , Wire (shroud) cutter

Sails: Electric winch

Yacht electrics: Battery charger , Battery storage system, Heating, Inverter, Shore connection 220 V, Solar panels

