

BAVARIA CRUISER 37

Paloma

Le voilier Bavaria Cruiser 37 „Paloma“, construit en 2024, est amarré à Elba, Portoferraio, Elba - Italie. Le yacht dispose de 3 cabines, peut accueillir 6 + 1 personnes et possède 1 toilettes/douches.

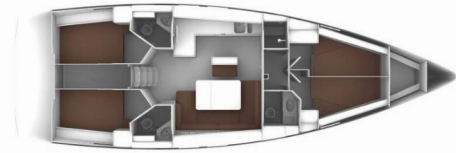

CARACTÉRISTIQUES DU YACHT

Base De Location

Elba, Portoferraio, Italie

Yacht ID

519

Marque

Bavaria Yachtbau

Nom

Paloma

Année De Production

2024

Longueur

11.30 m

Cabins

3

Couchages

6 + 1

Max. Passagers

7

Toilettes/Douche

1

ÉQUIPEMENT STANDARD DU YACHT

Deck

Anchor swivel, Bimini top, Black ball, Black conus, Boat hook, Bosun's chair (Safe seat) (boatswain's chair), Cockpit table, Cockpit/stern, outside shower, Dinghy, Dinghy (byboat) pump, Electric anchor windlass, Fenders, Gangway, Impeller, V-belt, oilfilter, Main anchor, Mooring ropes , Repair box for dinghy, Round/globular fender, Spare anchor (Reserve, Auxiliary anchor), Spotlight / Headlights, Sprayhood, Teak cockpit, Water hose

Entertainment

Outdoor speakers, Radio (Fusion MS-RA770 Apollo (AM, FM, Bluetooth, WiFi, AUX, USB))

Galley

Gas bottles, Hot water, Kitchen utensils (Galley equipment, cutlery), Refrigerator (Top loader, 147 l)

Interior

Barometer, Clock

Navigation

Autopilot, Bow thruster, GPS chart plotter - cockpit (B&G Zeus³S 7" with integrated GoFreeTM Wi-Fi), Harbour guides, Logge/Lot/Speed/Wind, Navigation (Nautical) charts and nautical guide , Navigation set, Radar reflector, Spyglass with bearing compass, Windex

Safety

Distress signals, EPIRB-Distress radio beacons, Fire extinguisher , First aid kit , Flashlight, Fog horn, Life belts (Safety harness), Life buoy + Flashing light, Life jackets, Lifelines, Liferaft , Railing net (Safety net), Set of tools , VHF radio (B&G V60 with integrated AIS receiver), Wire (shroud) cutter

Yacht electrics

Battery charger , Battery storage system (BOS LE300 Lithium / 200 Ah), Heating (Warm air heating, 4.0 kW (salon and front cabin)), Shore connection 220 V, USB sockets (2 x at the navigation table and 1 x in each cabin)

PRICE / WEEKS

29.03. - 05.04.2025 1.291 € 2.090 €	05.04. - 12.04.2025 1.664 € 2.190 €	12.04. - 19.04.2025 1.664 € 2.190 €	19.04. - 26.04.2025 1.664 € 2.190 €
26.04. - 03.05.2025 1.816 € 2.390 €	03.05. - 10.05.2025 1.892 € 2.490 €	10.05. - 17.05.2025 2.044 € 2.690 €	17.05. - 24.05.2025 2.196 € 2.890 €
24.05. - 31.05.2025 2.348 € 3.090 €	31.05. - 07.06.2025 2.424 € 3.190 €	07.06. - 14.06.2025 En option	14.06. - 21.06.2025 2.500 € 3.290 €
21.06. - 28.06.2025 2.804 € 3.690 €	28.06. - 05.07.2025 2.804 € 3.690 €	05.07. - 12.07.2025 2.880 € 3.790 €	12.07. - 19.07.2025 3.032 € 3.990 €
19.07. - 02.08.2025 Réservé			



WEB

www.suncharter.de

TÉLÉPHONE

+49 (0)8171 299 05

ADRESSE E-MAIL

info@suncharter.de

SUN CHARTER

Hans-Urmiller-Ring 11, D-82515, Wolfratshausen, Allemagne



PRICE / WEEKS

02.08. - 09.08.2025 3.488 € 4.590 €	09.08. - 16.08.2025 3.488 € 4.590 €	16.08. - 23.08.2025 3.336 € 4.390 €	23.08. - 30.08.2025 3.260 € 4.290 €
30.08. - 06.09.2025 3.260 € 4.290 €	06.09. - 13.09.2025 3.184 € 4.190 €	13.09. - 20.09.2025 3.032 € 3.990 €	20.09. - 27.09.2025 3.032 € 3.990 €
27.09. - 04.10.2025 2.880 € 3.790 €	04.10. - 11.10.2025 2.804 € 3.690 €	11.10. - 18.10.2025 2.576 € 3.390 €	18.10. - 25.10.2025 2.044 € 2.690 €
25.10. - 01.11.2025 1.892 € 2.490 €	02.11. - 31.12.2025 Réservé		



WEB

www.suncharter.de

TÉLÉPHONE

+49 (0)8171 299 05

ADRESSE E-MAIL

info@suncharter.de

SUN CHARTER

Hans-Urmiller-Ring 11, D-82515, Wolfratshausen, Allemagne

